

137. PODZIAŁ  
T-5147:  
OBW.04,  
Z33047:  
KRSN-P

Z-303/2  
KRSN-P2/2F-NH2/2R-NH00/F

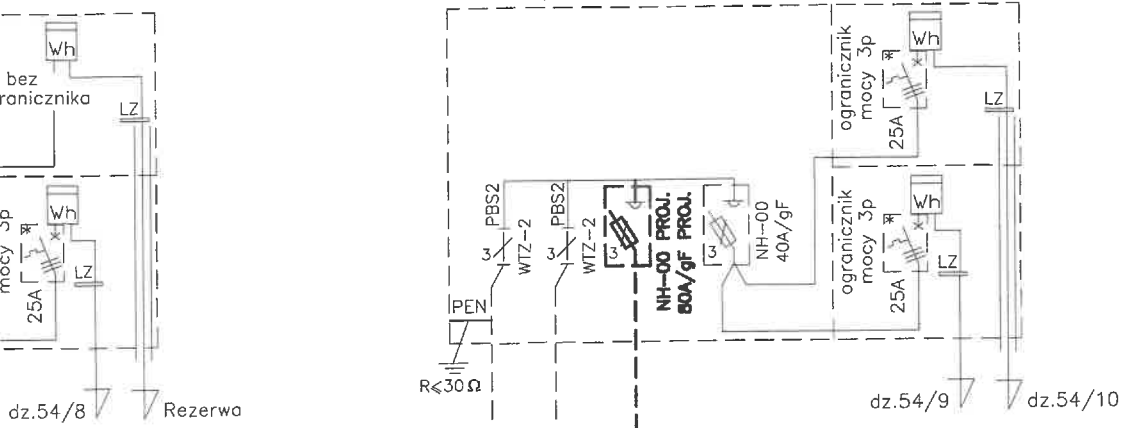

YAKXS 4x120 l=53m "300"  
+Fe/Zn 25x4

Z3311670 PROJ.  
KRSN-P2/2F-NH2/R-NH00/F

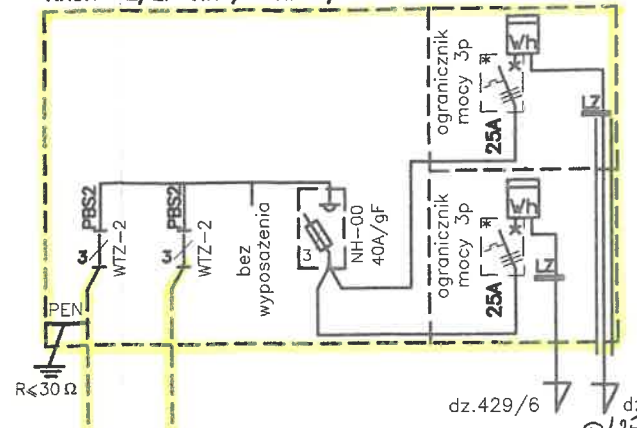

YAKXS 4x120+Fe/Zn 25x4 l=2x14m(2x9m) PROJ.  
2xMUFA KABLOWA PRZELOTOWA (MP-DM 120) PROJ.

YAKXS 4x120 l=33m "300"  
+Fe/Zn 25x4

Z-303/3 ISTN.  
Z3311671 PROJ. NR  
KRSN-P2/2F-NH2/2R-NH00/F

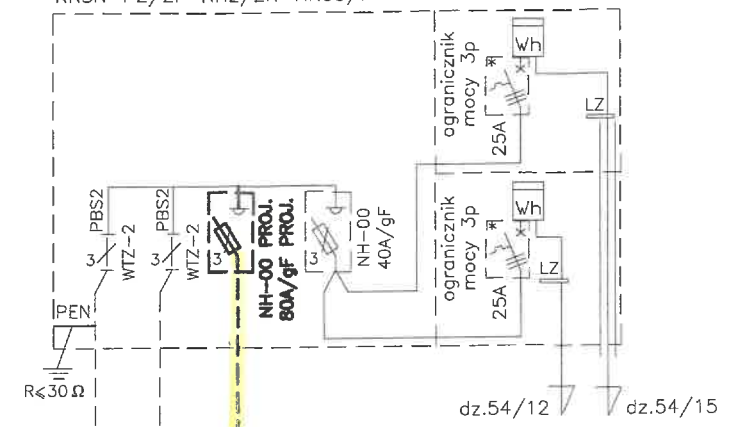

YAKXS 4x120 l=62m "300"  
+Fe/Zn 25x4

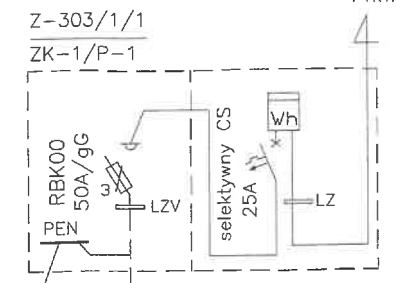

dz.429/1  
Przepompownia  
14kW

3m "300"  
x4

Z3311673 PROJ.  
P2-R0/LZV/LZR/F

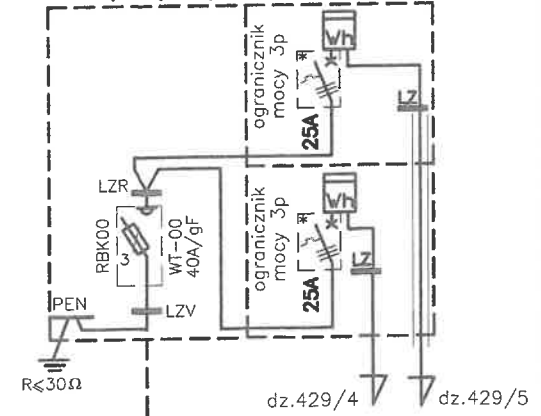

PROJ.  
YAKXS 4x35 l=32m(26m) "300"  
+Fe/Zn 25x4

Z3311672 PROJ.  
P2-R0/LZV/LZR/F

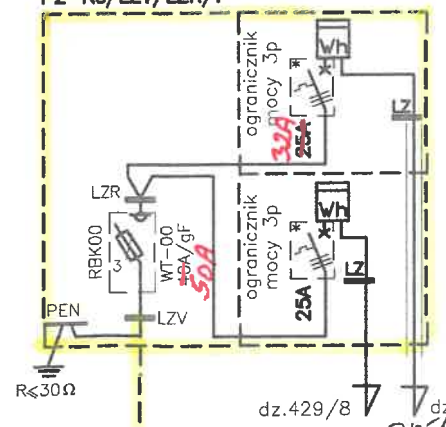

PROJ.  
YAKXS 4x35 l=33m(27m) "300"  
+Fe/Zn 25x4

dz.429/9  
P251071815  
16,54W